

Steve's 5 km to Run Down Cancer, Mendon Ponds Park, Mendon, New York

Measured on: April 19, 2014, By: Kevin P. Lucas - 585-421-9626

Measured Marks:

Start: on Douglas Road, between beach parking & Stewart Lodge,

35 feet South of power pole #9 on East side of road.

1 Mile: on Hopkins Point Road, 34 feet 10" West of

power pole #3 on South side of road.

2 Mile: on Hopkins Point Road, 35 feet 1" South of

power pole #4 on North side of road.

3 Mile: on Stewart Lodge drive,

107 feet West of drive

gate at Douglas.

Finish: at Stewart

Lodge, 25 feet East

of Western most

lot posts.

Elevations:

Start = 712 feet

Finish = 679 feet

Highest = 712 feet

Lowest = 644 feet



NY14103KL

Effective

04/22/2014 to

12/31/2024

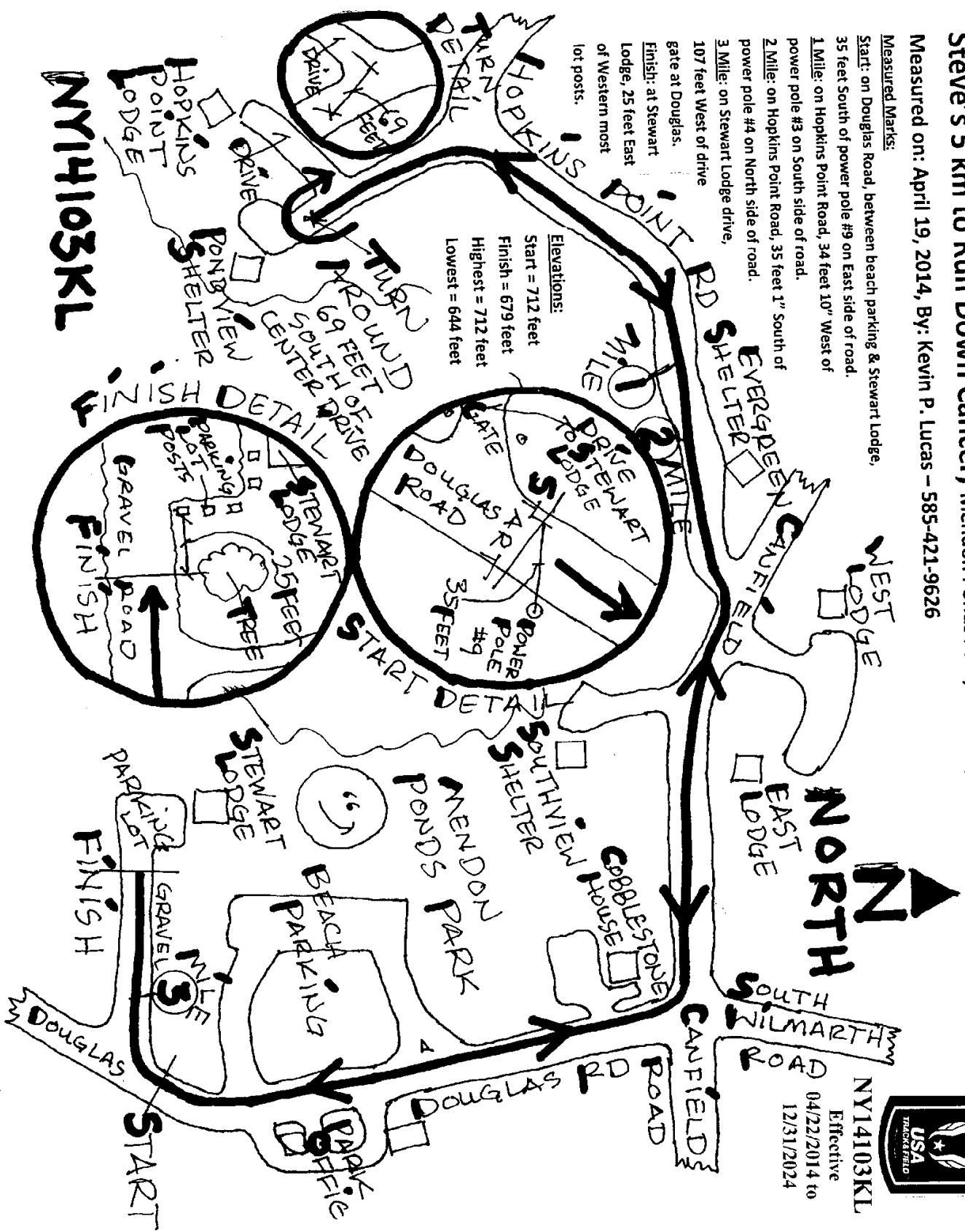

NY14103KL

